

2016  
**DYNASTY**



**MONACO**



# RETURN TO POWER

Luxury speaks volumes. The elegant style and design of the 2016 Dynasty radiates impressive beauty with each intricate accent in every detail throughout.



DYNASTY 45P shown in Classic Radiance décor with Glazed Italian Sienna wood cabinetry.



The remarkable craftsmanship of the 2016 Dynasty extends intuitive design features at every turn throughout to provide a true luxury experience.



DYNASTY 45P shown in Satin Silhouette décor with Glazed Dark Cherry wood cabinetry.



# STANDARD AND OPTIONS

## INTERIOR GENERAL AMENITIES

- 12V LED Ceiling & Task Lighting
- Soft Touch Padded Ceiling w/Decorative Trim
- Decorative Soffits w/Crown Molding
- Fully Concealed & Adjustable Cabinet Door Hinges
- Integrated Latch Hardware in Pocket Doors
- Hardwood Window Treatments
- Interior MultiPlex Power Management System
- Lined Cabinet Interiors
- Polished Porcelain Tile Floor
- Premium Hardwood Custom Cabinetry & Moldings
- Solid-Surface Entry-Step w/LED Accent Lights & Storage
- Wood-Trimmed Fan-Tastic® Rain Sensor, Power Roof Vents w/3-Speed Fan (3)
- Heated Electric Radiant Tile Floor

### OPTIONS

**OPT560** - Factory V.I.P. Delivery

**OPT693** - Custom Interior Request

## DRIVERS CONVENIENCE

- Adjustable Brake & Throttle Pedals
- Auxiliary Fog Lamps
- Auxiliary Start Switch
- Memory Driver Seat
- Memory Steering Column
- Chrome, Heated Side-View Mirrors w/Remote Adjustment & Turn Signal Indicators, Side Vision Cameras Integrated Into Mirrors
- Color Camera Monitor w/One-Way Audio
- Driver & Passenger LED Reading Lights
- Dual-Dash Monitor Design
- Air Horns
- Halogen Head Lamps
- I.C.C. Light Switch
- Integrated Rand McNally® RV GPS
- Keyless Entry Door Access w/Key Fob
- Low-Profile Automotive-Style Dash w/Burlwood Accents
- Backlit Gauges & Switches
- Multiple Auxiliary 12-Volt Dash Receptacles
- Powered Windshield, Driver & Passenger Privacy Blinds & Shades
- Pressure Pro® Active Tire Pressure Monitoring System
- SGM Dash HVAC System w/Additional Defrost Blower
- Silverleaf® Chassis Monitoring System
- Sirius® Satellite Radio Ready (Subscription Required)
- Smart Wheel w/Leather & Burl Wood Trim w/Manual Tilt/Tip/Telescope
- Sony® Rear-View Camera
- Intermittent Windshield Wiper System w/Wet Arm
- Villa® Ultraleather™ 6-Way Power Passenger Seat w/Heat, Power Lumbar, Adjustable Arms & Electric Footrest
- Villa Ultraleather 6-Way Power Driver Seat w/Heat, Power Lumbar & Adjustable Arms
- Xite® 7" Touch Screen Dash Radio w/Handsfree Bluetooth

### OPTIONS

**OPT580** - Collision Warning System

## LIVING AREA

- Central Vacuum System w/Sweep-in Toe Kick
- Centralized Command Center
- Desk Workstation w/Pop-Up 110V/USB Outlet
- Electric Fireplace w/Remote, 5,200 Btu/h
- Hardwood Front TV Overhead Cabinetry
- Large Passenger Window
- Lighted Step Well Area w/Power Cover
- Sony 48" LED HDTV w/Sound Bar & Subwoofer Mid-coach (45P)
- Sony 48" Pop-Up LED HDTV w/Sound Bar & Subwoofer Mid-coach (45D)
- Sony Blu-ray® DVD w/Wi-Fi
- Power Roller Shades & Privacy Blinds
- Satellite Pre-Wire Package

### OPTIONS

**OPT087** - Front Overhead 48" Sony LED TV

**OPT092** - KVH In-Motion Satellite System

**OPT095** - Winegard® In Motion Satellite System

**OPT570** - iPad® Controller for Lights, Blinds & A/V

## GALLEY

- Adjustable Shelves Throughout
- Appliance Garage (45P)
- Countertop Decorative Edge Treatment
- Decorative Backsplash
- Dual Pull-Out Trash Receptacles (45P)
- Flush-Mount Electric 2-Burner Induction Cooktop
- French Door Residential Refrigerator w/Icemaker In Door
- High-Rise Single-Level Galley Faucet w/Sprayer
- Polished Solid-Surface Countertop & Flush Sink Covers
- Pop-Up Appliance Valet (45P)
- Pull-Out Counter Extension (45P)
- Roller Bearing Full-Extension Drawer Guides
- Stainless Steel Under-Mount Double-Bowl Sink
- Stainless Steel Convection Microwave Oven
- Toe-Kick LED Accent Lighting

### OPTIONS

**OPT107** - Dishwasher Drawer

## BEDROOM

- Cedar-Lined Wardrobe
- Serenity Series Memory Foam Queen Mattress
- Full-Length Rear Wardrobe
- Hardwood 6-Panel Doors - (45D, 45P)
- Key-Actuated Hidden Safe
- Lift-Up Bed w/Under-Bed Storage
- Overhead Cabinetry Above Bed
- Polished Solid-Surface Counter & Nightstand Tops
- Power Roller Shade & Privacy Blind
- Remote Generator Start Switch
- Shoe Storage Rear Wardrobe
- Sony Blu-ray® DVD Player
- Sony 40" LED HDTV
- Stacked Washer/Dryer
- Two-Speed Ceiling Fan
- Two Nightstands Each w/110V & USB Outlets

### OPTIONS

**OPT126** - Combination Washer/Dryer

**OPT129** - Washer/Dryer Ready w/Shelves

**OPT856** - King Air Mattress

## FURNITURE

- Decorative Dinette & Folding Guest Chairs
- Deep-Base Dinette Cabinet Storage Credenza
- Polished Solid-Surface Dinette Table w/Slide-Out Extension
- Villa Ultraleather Sofa Bed w/Air Mattress
- Freestanding Ultraleather Desk Chair (45P)

### OPTIONS

**OPT195** - Electric Jackknife L-Sofa w/Storage Drawer

**OPT832** - Freestanding Round Dinette Table & Chairs

**OPT878** - Captain's Desk Chair Upgrade

## BATHROOM

- Decorative Custom Tile Backsplash
- Chrome Luxury Series Faucet
- Large Glass-Door Shower Enclosure
- Large Skylight in Shower
- Manual Roller Shade & Privacy Blind
- Master Bath Under-Mount Glass Bowl Sink w/LED Accents - (45D, 45P)
- Guest Bath Polished Solid-Surface Countertop & Integrated Sink
- Residential Hand-Held Shower Head
- Solid-Surface Shower Surround w/Hand-Laid Tile Inlay
- Tecma® Silence Plus 2-Button Porcelain Vacuum Flush Toilets (2)



## PLUMBING/ELECTRICAL

- AquaHot™ 450D Heating System
- Auto Generator Start
- Energy Management System (50 Amp)
- Gravity & Pressurized Fresh Water Fill
- Heat Pump on Rear AC Unit
- Heated Water & Holding Tank Compartments
- Holding Tank San-T-Flush™ System
- Inverter & Battery Monitor
- Multi-Point Water Pump Switching
- PEX Plumbing System
- Power Control System Monitor
- Roof Condensation Drains
- SensaTank™ Level Monitoring System (Interior and Exterior Monitor)
- Surge Guard™ Electrical System Protection
- Three 15.0M Low-Profile Roof Air Conditioners
- Variable-Speed On-Demand Water Pump
- Whole Coach Water Filtration System
- Waste Management System
- Power Water Hose Reel

### OPTIONS

**OPT134** - AquaHot™ 600

## SAFETY

- 3-Point Integrated Seat Belts at Driver & Passenger Seats
- Carbon Monoxide (CO) Detector
- Daytime Running Lights
- Deadbolt Lock on Entry Door
- Emergency Egress Window
- Fire Extinguisher
- High-Mounted Third Brake Light
- Key-Actuated Hidden Safe
- Lighted Exterior Grab Handle
- Momentary Courtesy Lighting at Entry & Passenger Area
- Side Docking Lamps
- Side Turn Signal Indicators
- Smoke Detector/Alarm

## EXTERIOR GENERAL AMMENITIES

- Battery Disconnect Switches for House & Chassis
- Brushed Stainless Kick Plate Under Entry Door
- Chrome Luggage Door Handles
- Cummins Onan® 10.0 kW Quiet Diesel Generator
- Electrical Outlets in Luggage Compartments
- Full-Width Rear Rock Guard w/Stainless Logo Panel
- Keyless Entry Touch Pad
- Large Rear Engine Access Door w/Lift Assist Struts
- LED Clearance Lights
- Maintenance-Free (8) Absorbed Glass Mat 6-Volt Batteries
- Power Bus-Style Double Entry Step
- Remote Power Cord Reel (50 Amp)
- Power Luggage Door Locks (Select Doors) w/Remote Key Fob
- Powered Slide-Out Generator Access Tray
- Protective Front Mask
- Pure Sine Wave Inverter/Charger (2800w)
- High-Mounted Engine Air Intake
- Solar Charging Panel (95w)
- Power Cord Reel (50 Amp)
- Tray Pkg-A w/ 2-90" Power Slides
- Tray Pkg-B w/ 1-54" Manual, 1-36" Manual & 1-90" Power Slide
- Exterior Drop-Down TV (Sony 40" LED) - (45D, 45P)

### OPTIONS

**OPT035** - Custom Exterior Paint Color Request

**OPT051** - Two-Piece Aluminum Rear Ladder

**OPT325** - 12K Generator



## AWNINGS/DOORS/WINDOWS

- Air Seal Dual-Latch Wide Entry Door w/Screen Door
- Dual Girard® Nova 2-stage Awnings (2) w/LED Lights, Wind Sensor & Remote
- Large Frameless Tinted Tilt-Out Windows
- Power Pilot Window
- Power Entry Door Awning
- Slide-out Topper Awnings

### OPTIONS

**OPT271** - Additional Window Awning Pkg (Charcoal)

**OPT272** - Additional Window Awning Pkg (Linen)

## EXTERIOR BODY CONSTRUCTION

- Acoustic Absorption Material in Front, Rear & Engine Compartment
- Aluminum-Framed Wall, Roof & Floor Construction
- Full Fiberglass Front & Rear Caps
- Gel Coat Fiberglass Sidewalls w/No Wood Substrate
- 6-Layer Radius Roof w/up to 5" Foam Insulation
- 5-Layer Floor w/3" Foam Insulation
- Molded Fiberglass Fenders
- One-Piece Bonded Front Windshield
- One-Piece Molded Fiberglass Roof
- Axalta™ Automotive Sand/Buf 5-Color Full Body Paint w/Fades & High Gloss Finish
- Reinforced Interlocking Aluminum Connections at Roof, Sidewall & Floor
- Seamless Cap to Sidewall Transitions
- Insulated Strut-Assisted Side-Hinged Luggage Doors
- Vacu-bond® Sidewall, Roof, Floor & Rear Wall

## ALL NEW ROADMASTER™ CHASSIS

- Anti-Lock Brake System (ABS)
- Automatic 4-Point Dual (Air & Hydraulic) Leveling System
- Automatic Traction Control
- Custom Tuned Sachs® Shocks
- (6) Dual High-Flow Fuel Fill w/Locking Doors
- Easy Access Remote Filter Location
- Engine Block Heater (1500 Watt)
- Front Air Disc Brakes & Rear Drum Brakes
- Heavy-Duty E-Coated Steel Roadmaster Bridge
- Neway® Air Suspension w/Large Volumetric Air Bags (6)
- Polished Aluminum Wheels (6) 22.5 x 9
- Protective Spray-On Undercoating
- Remote Air System Connection w/Hose & Fittings
- Side-Mounted Aluminum Radiator w/CAC
- Tag Axle w/ Air Dump Control
- Two 1900 CCA Maintenance-Free Chassis Batteries
- ZF® Independent Front Suspension w/60-Degree Steering Angle

## AT YOUR FINGERTIPS





# 45DUKE

# 45PALACE

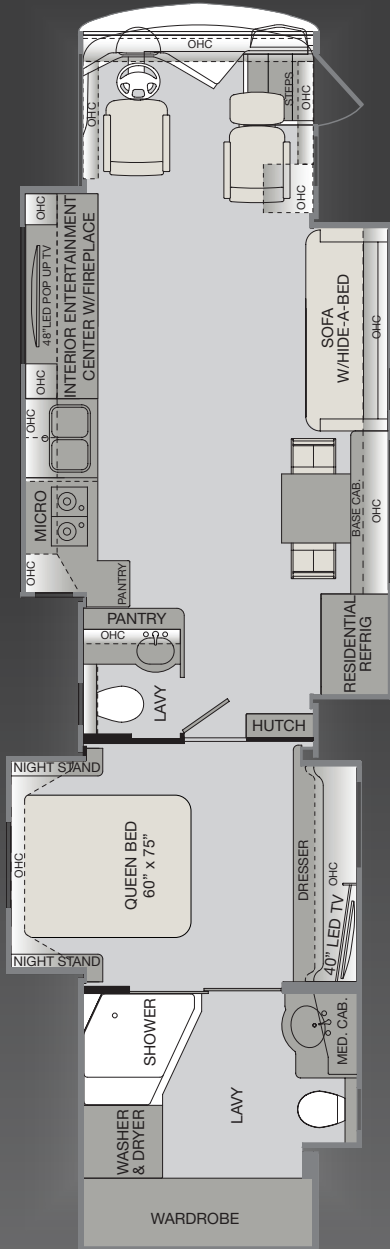

Available options: 087, 107, 126, 129, 832, 856

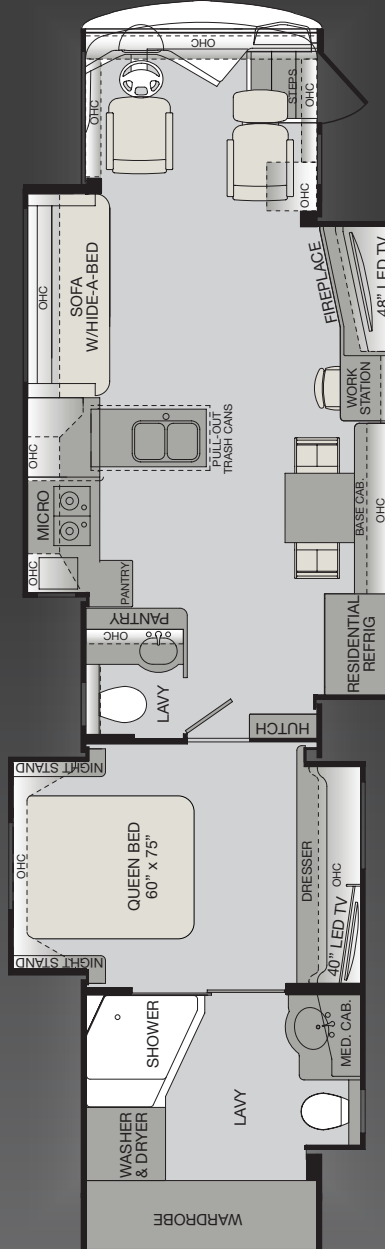

Available options: 087, 107, 126, 129, 195, 832, 856, 878



## FURNITURE OPTIONS

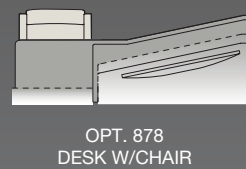
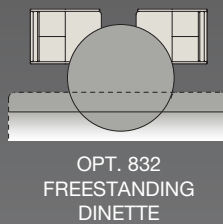
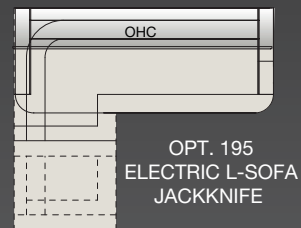



## EXTERIOR/INTERIOR DÉCOR

"Build Your Own" at [monacocoach.com](http://monacocoach.com)



CLASSIC RADIANCE

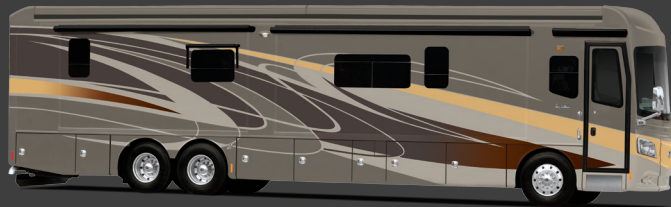

GRAND CANYON SUNSET

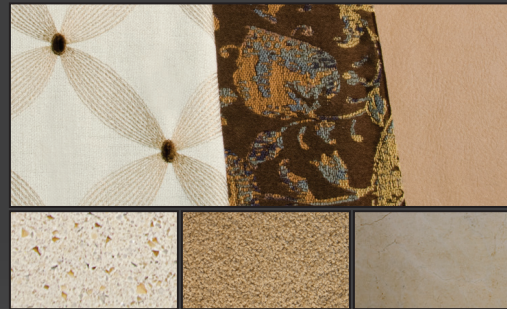

SATIN SILHOUETTE

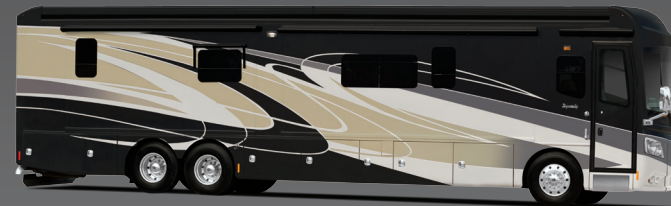

VAPOR MIST

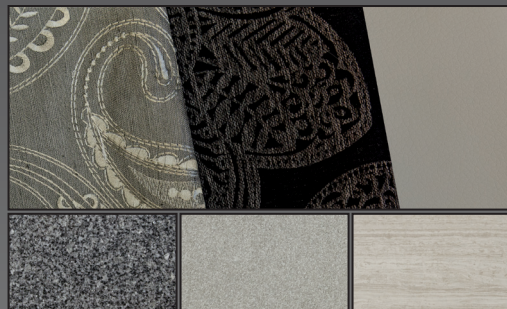

GLAZED DARK CHERRY



GLAZED ITALIAN SIENNA

\*Interior décors and/or woods may be subject to change. Printed samples are representations of actual fabrics and may be limited due to standard printing technology.



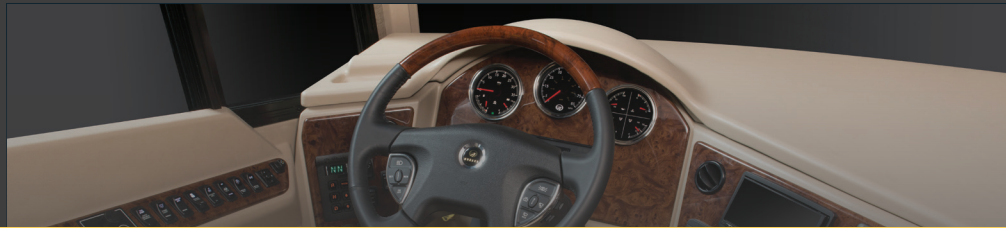

## WEIGHTS & MEASUREMENTS

ROADMASTER™ CHASSIS	600i	B500i/B600i
MODELS	45D	45P
GVWR (lbs) <sup>1</sup>	51,000	51,000
Front GAWR (lbs) <sup>2</sup>	17,000	17,000
Rear GAWR (lbs) <sup>2</sup>	20,000	20,000
Tag Axle GAWR (lbs) <sup>2</sup>	14,000	14,000
GCWR (lbs) <sup>3</sup>	66,000	66,000
Hitch Rating (lbs) <sup>††</sup>	15,000	15,000
Tongue Weight (lbs) <sup>†</sup>	1,500	1,500
Fuel Capacity (gal)	150	150

### ROADMASTER™ B500i

Model: Freightliner® SLM Series Alternator: 270 Amp Leece-Neville  
 Engine: Cummins® 12L ISX Torque: 1,645 lb-ft @ 1,200 RPM  
 w/3-Stage Engine Brake Horsepower: 500 HP  
 Transmission: Allison® 4000 MH 6-Speed w/Electronic Shift  
 Tires: 315/80R 22.5" Michelin® Radial (8)

### ROADMASTER™ B600i

Model: Freightliner® SLM Series Alternator: 270 Amp Leece-Neville  
 Engine: Cummins® 15L ISX Torque: 1,950 lb-ft @ 1,200 RPM  
 w/3-Stage Engine Brake Horsepower: 600 HP  
 Transmission: Allison® 4000 MH 6-Speed w/Electronic Shift  
 Tires: 315/80R 22.5" Michelin® Radial (8)

## DIMENSIONS & CAPACITIES

MODELS	45D	45P
Wheelbase (inches)	302"	302"
Overall Length <sup>4</sup>	44' - 11.5"	44' - 11.5"
Overall Height (with A/C)	12' - 11"	12' - 11"
Overall Width (maximum) <sup>5, 6</sup>	102"	102"
Interior Height (maximum)	84"	84"
Interior Width (maximum)	96"	96"
Fresh Water Holding Tank (gal)	100	100
Grey Water Holding Tank (gal)	60	60
Black Water Holding Tank (gal)	40	40



# The all-new Roadmaster Chassis

Designed and built to deliver the very best motorhome experience, The All New Roadmaster Chassis utilizes a more rigid, advanced bridge design, engineered in tandem with Freightliner Custom Chassis. The new design features unique attributes like an electro-coated bridge structure, ZF® independent front suspension, and the industry's only volumetric air bags paired with custom tuned shocks for the responsive handling you expect from Roadmaster™.



## RETURN TO POWER

### ADDENDUMS

- GVWR (Gross Vehicle Weight Rating) is the maximum permissible weight of this fully loaded motorhome. The GVWR is equal to or greater than the sum of the (UWW) unloaded vehicle weight plus the (OCCC) occupant cargo-carrying capacity\*.
- GAWR (Gross Axle Weight Rating) is the maximum permissible loaded weight a specific axle is designed to carry.
- GCWR (Gross Combined Weight Rating) is the value specified by the motorhome manufacturer as the maximum allowable loaded weight of this motorhome with its towed vehicle. Towing and braking capacities may be different. Refer to Monaco and chassis manufacturer's manuals for complete information.
- Length measured from front bumper to rear bumper (excludes accessories).
- Excludes safety equipment and awnings.
- Motorhomes feature a body width over 96" which will restrict your access to certain roads. Before purchasing, you should research any state and/or province road laws which may affect your usage.
- Tank manufacturer's listed water capacity (WC). Actual propane capacity is 80% of water listing as required by the safety code.

† The chassis manufacturer recommends the installation of a supplemental brake control system to activate the brakes on the vehicle or trailer you are towing. Hitch receiver ratings expressed are maximum for the hitch receiver installed and may require the purchase of additional equipment that is dependent on the weight of the towed load. Consult with hitch receiver manufacturer for further information.

†† The Minimum Towable Load of this vehicle is the available weight capacity, up to GCWR, when the coach is fully loaded to maximum GVWR. However, if the coach is loaded to something less than

maximum GVWR, that extra available weight capacity can be added to your Towable Load. For example, if your coach is loaded to 1000lbs less than maximum GVWR, your Towable Load increases accordingly. Do not exceed the hitch rating weight, GVWR or GCWR.

\* UWW and OCCC are found on the label containing the federal certification tag in each RV.

### IMPORTANT—PLEASE READ

Product information, photography and illustrations included in this publication were as accurate as possible at the time of printing. For further product information and changes, please visit our website at [www.monacocoach.com](http://www.monacocoach.com) or contact your local Monaco dealer. Prices, materials, design and specifications are subject to change without notice. All weights, fuel, liquid capacities and dimensions are approximate. Monaco has designed its recreational vehicles to provide a variety of uses for customers. Each vehicle features optimal seating, sleeping, storage and fluid capacities. The user is responsible for selecting the proper combination of loads (i.e., occupants, equipment, fluids, cargo, etc.) to ensure that the vehicle's capacities are not exceeded.

### WARRANTY INFORMATION:

Enjoy your next RV adventure with the peace of mind that comes with a 12 month/24,000 mile basic limited warranty; a 5 year/50,000 mile limited warranty on aluminum or steel frame structure; and a 3 year/50,000 mile limited warranty on the Chassis. Review your coach's limited warranty in full for complete terms and conditions.

### SERVICE AND SUPPORT:

24/7 service and support – Toll-free 877-211-8135

©2015 Allied Recreation Group, Inc. Printed in USA. Inventory Control Number DYN16B1, 05/15. Model Year 2016, First Edition.